

## Cable Conduit / Trunking

- **PVC Mini Trunking - Self Adhesive White**
- **Half Circle Trunking**
- **Elastomer Hinge, Lid cannot detach**
- **Can be drilled**
- **Light weight, easy to handle and cut.**
- **Self Extinguishing**



A single-piece self-extinguishing plastic semi-circular trunking having elastomer (plasticised-rubber) hinged lid at one side and clip-in fastening facility at the other side, available in a variety of contemporary finishes and available with a full range of fast-fit male insert flush fitting accessories to conceal and protect surface cabling.

To be fixed on a wall or ceiling.

## Specifications

Code	Width (W)	Length (L)	Height (H)	Paintable	Hinge	Weight	Quant. Per Pack
ML-SLG-0004	16.0	3000.0	8.0	Yes	Lid cannot detach	0.7kg per Metre	1

## Material Specifications

Material	Operating Temperature	Flammability	UV Stable	Approvals
PVC	-30 °C to +60 °C	Self-Extinguishing	Will not discolour or turn brittle in sunlight	BS EN 50085 - 1.2005 Part 1

## Accessories



**ML-SLG-0007**  
16mm x 8mm  
Flat Bend  
White

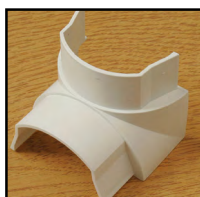

**ML-SLG-0011**  
16mm x 8mm  
Internal Bend  
White



**ML-SLG-0012**  
16mm x 8mm  
External Bend  
White



**ML-SLG-0009**  
16mm x 8mm  
Plain Coupler  
White



**ML-SLG-0008**  
16mm x 8mm  
Equal Tee  
White



**ML-SLG-0010**  
16mm x 8mm  
End Cap  
White